

remote linear LED power supply

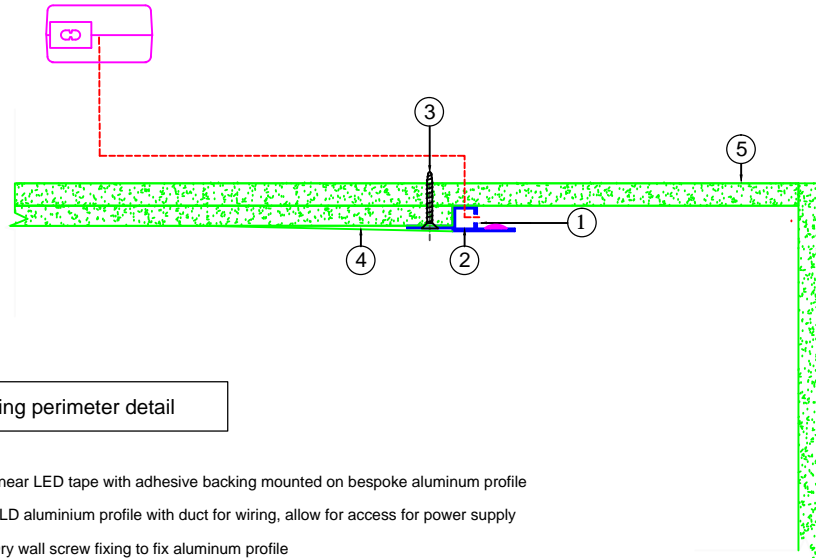

Ceiling perimeter detail

- ① Linear LED tape with adhesive backing mounted on bespoke aluminum profile
- ② ALD aluminium profile with duct for wiring, allow for access for power supply
- ③ Dry wall screw fixing to fix aluminum profile
- ④ Aluminum profile edge to be tape and filled to allow for a smooth feathered off finish suitable for decoration
- ⑤ Gypsum board

remote linear LED power supply

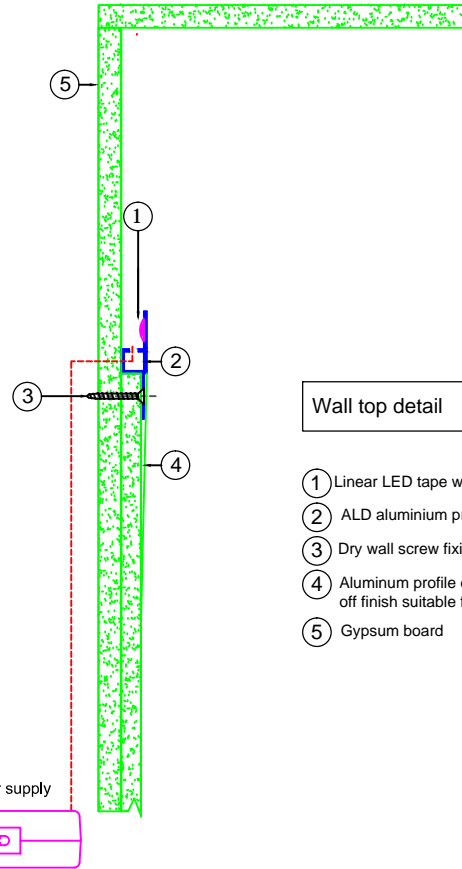

Wall top detail

- ① Linear LED tape with adhesive backing mounted on bespoke aluminum profile
- ② ALD aluminium profile with duct for wiring, allow for access for power supply
- ③ Dry wall screw fixing to fix aluminum profile
- ④ Aluminum profile edge to be tape and filled to allow for a smooth feathered off finish suitable for decoration
- ⑤ Gypsum board